

Sunrino SP Series

Low Frequency Split Phase Solar Inverter



MAIN FEATURES:

- Rated power 4kw to 12kw, with DSP control
- Pure sine wave, split phase output
- Built-in MPPT solar charge controller
- Low frequency with transformer
- Configurable AC/ solar input priority via LCD setting
- Compatible to mains voltage or generator power
- WiFi/ GPRS remote monitoring
- RS485 communication for BMS

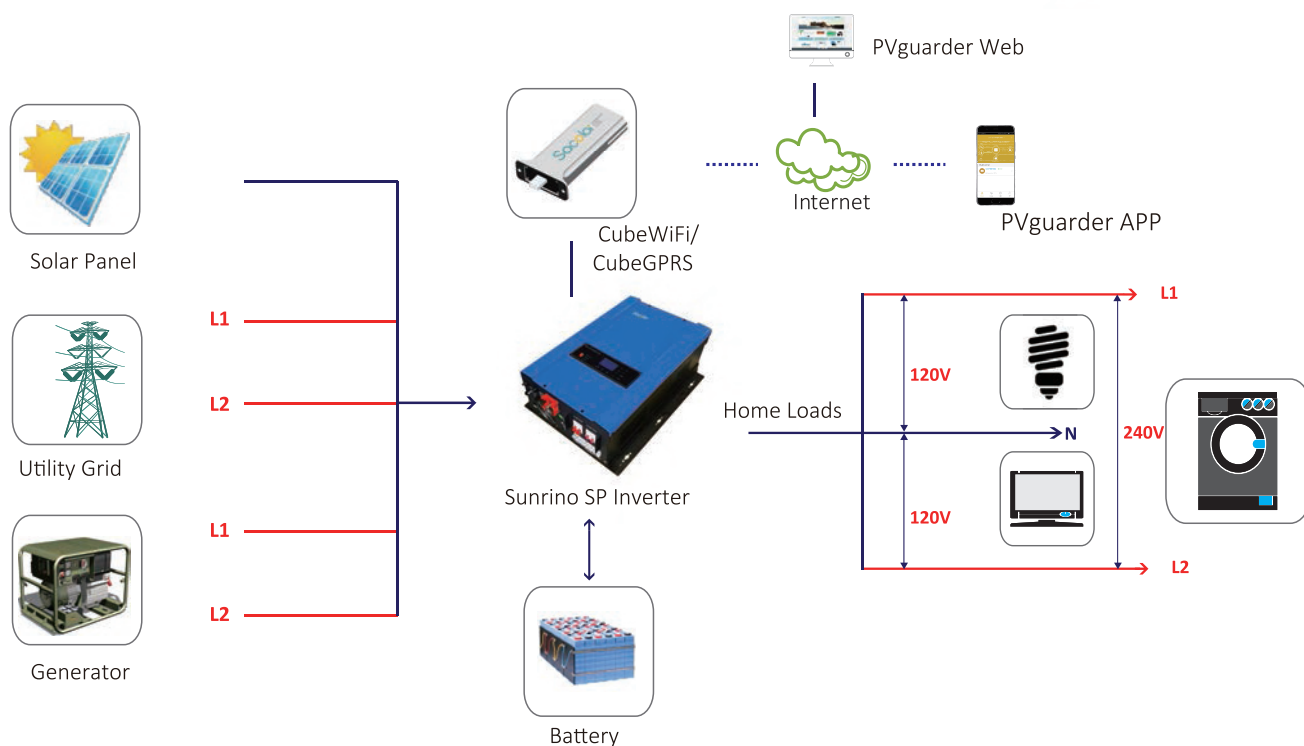

INTRODUCTION:

Sunrino SP series solar inverter is with split phase 120V/240V output, which combined functions of inverter, PV charger and AC charger. The comprehensive LCD display controller gives configurable and easily accessible operation such as battery charging current, AC/solar charger priority, and selectable input voltage based on different applications.

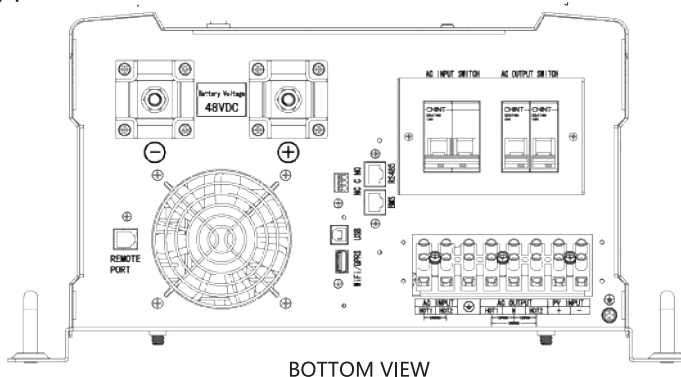

Low Frequency Solar Inverter

SPECIFICATION

Model	Sunrino-SP 4KW	Sunrino-SP 5KW	Sunrino-SP 6KW	Sunrino-SP 8KW	Sunrino-SP 10KW	Sunrino-SP 12KW
Battery Voltage	48VDC	48VDC	48VDC	48VDC	48VDC	48VDC
Rated Power	4KW	5KW	6KW	8KW	10KW	12KW
Monitoring Option	WiFi or GPRS	WiFi or GPRS	WiFi or GPRS	WiFi or GPRS	WiFi or GPRS	WiFi or GPRS
INVERTER OUTPUT						
Output Voltage	104V-110V-115V-120VAC/ 208V-220V-230V-240V					
Surge Rating (20ms)	12KW	15KW	18KW	24KW	30KW	36KW
Capable Of Starting Electric Motor	2HP	2HP	3HP	4HP	5HP	6HP
Waveform	Pure sine wave	Pure sine wave	Pure sine wave	Pure sine wave	Pure sine wave	Pure sine wave
Output Frequency	50Hz/60Hz +/-0.3 Hz	50Hz/60Hz +/-0.3 Hz	50Hz/60Hz +/-0.3 Hz	50Hz/60Hz +/-0.3 Hz	50Hz/60Hz +/-0.3 Hz	50Hz/60Hz +/-0.3 Hz
SOLAR CHARGER & AC CHARGER						
Maximum PV Charge Current	80A	80A	80A	120A	120A	120A
Maximum PV Array Power	5000W	5000W	5000W	7000W	7000W	7000W
MPPT Operating Voltage	60~145VDC	60~145VDC	60~145VDC	60~145VDC	60~145VDC	60~145VDC
Maximum PV Array Open Circuit Voltage	150VDC	150VDC	150VDC	150VDC	150VDC	150VDC
AC Input Voltage	208V-220V-230V-240VAC					
Frequency Range	50Hz/60Hz(Auto sensing)					
Overcharger Protection	AGM:60V; FLD: 62V; USE: CV+4.0V					
Maximum AC Charge Current	40A	50A	60A	70A	80A	100A
Maximum Charge Current (PV+AC)	120A	130A	140A	180A	180A	180A
MECHANICAL SPECIFICATIONS						
Dimensions(W*H*D)	540*360*218mm	540*360*218mm	540*360*218mm	650*380*225mm	650*380*225mm	650*380*225mm
Net Weight(Solar CHG)kg	38	41	45	64	66	75
OTHERS						
Typical Transfer Time	10ms	10ms	10ms	10ms	10ms	10ms
Communication Interface	USB/RS485	USB/RS485	USB/RS485	USB/RS485	USB/RS485	USB/RS485
Operation Temperature Range	0°C to 55°C	0°C to 55°C	0°C to 55°C	0°C to 55°C	0°C to 55°C	0°C to 55°C
Storage Temperature	-15°C~60°C	-15°C~60°C	-15°C~60°C	-15°C~60°C	-15°C~60°C	-15°C~60°C